

HOW TO SWAP SCF FIN TO SCF MAIN

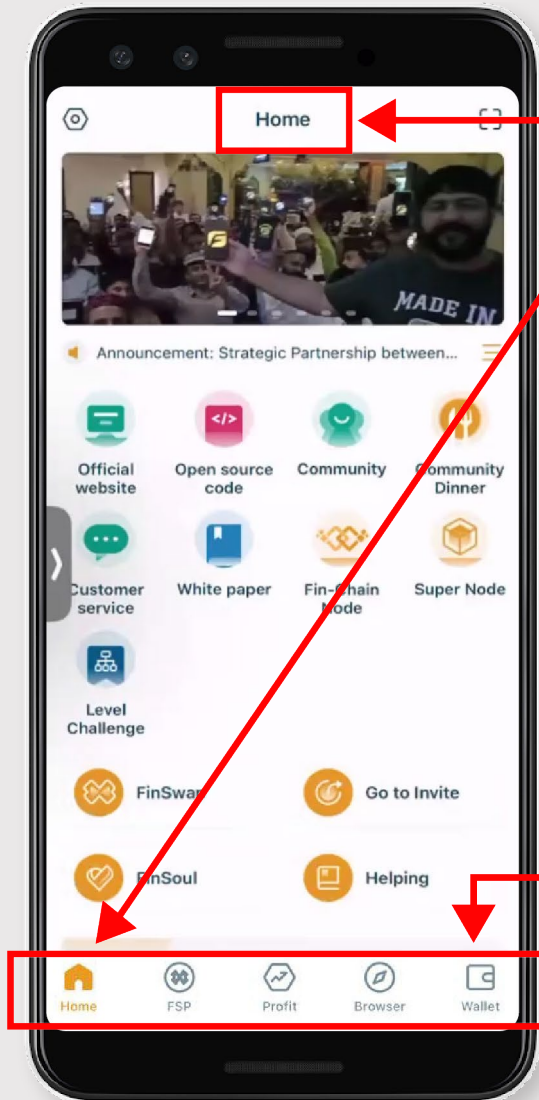

HOW TO SWAP - SCF FIN TO SCF MAIN



The FSP APP will open with the default **Home** screen

The menu icons at the bottom
Tap on "**Wallet**"

NOTE: The screen shots are from the iPhone, on the Android Phone the buttons & wording may be slightly different, but the procedures are the same!

At the top menu
Tap "**Swap**"

The bottom menu
Wallet is selected

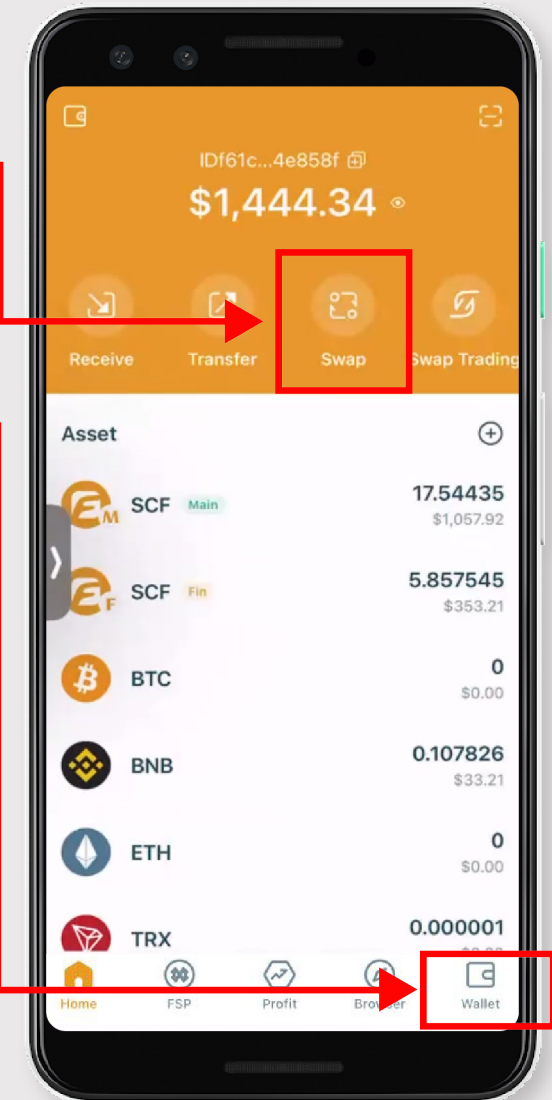

HOW TO SWAP - SCF FIN TO SCF MAIN

UNDERSTANDING THE WALLET SWAP FEATURE

SWAP SCREEN

Cross Out:
The Token or Coin you want to change out

Please enter the number:
Input amount you want to Swap out

Balance:
Current amount of Token or Coins in your wallet

Up Down Arrow:
Switch button, moves the Token or Coin on the top to the bottom & the Token or Coin on the bottom to move to the top

NOTE: Swapping crypto, the Token or Coin on the top is what you are getting rid of to the Token or Coin at the bottom

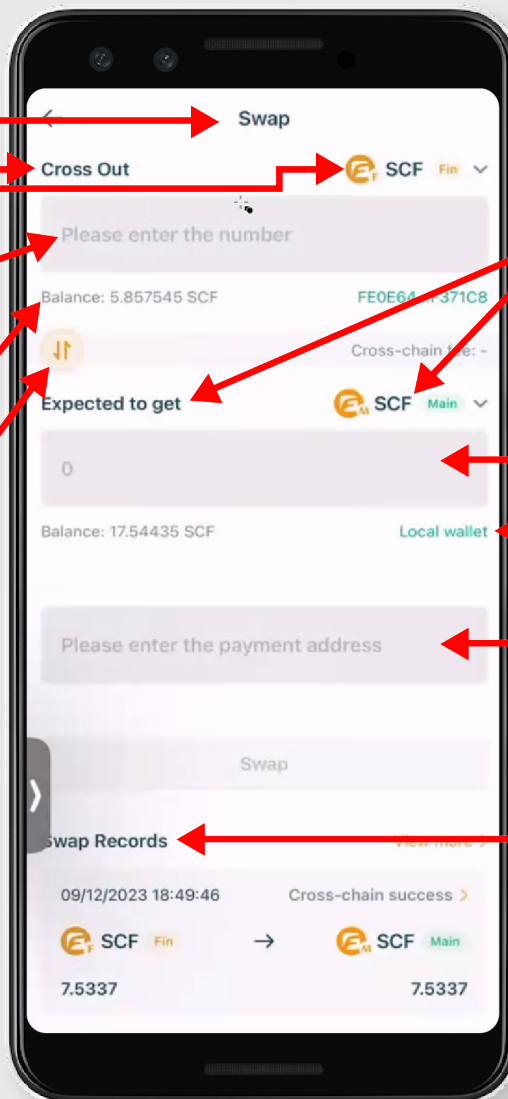

Expected to get:
The Token or Coin to be received

Amount you will get in the Token or coin you will receive

Local wallet:
This is a great feature that SCF created, instead of having to copy your Token or Coin receiving address, you can populate it with this feature.

Swap Records:
Below is the history of all your swaps



HOW TO SWAP - SCF FIN TO SCF MAIN

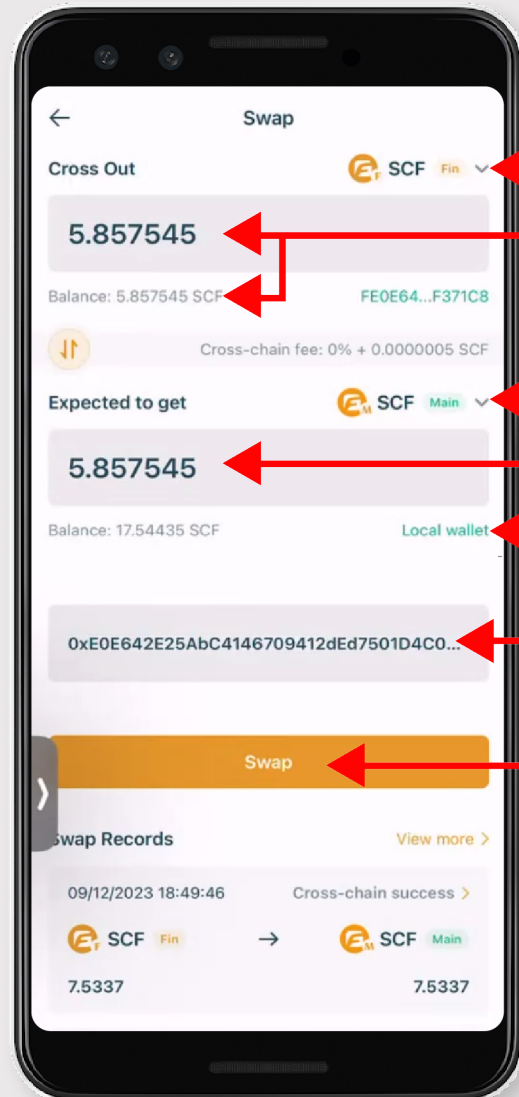

Cross Out:
SCF Fin, input the decimal amount you want to swap up to the amount you have in your Balance

Expected to get:
SCF Main, the decimal amount you will get after any fees

Tap **"Local wallet"**
This will input your Token or Coin Wallet Address

Tap on **"Swap"**

Error Message:

"Insufficient balance to pay mining fees"
If you get this error message, go to your Cross Out input numbers and remove one digit,

Tap **"Swap"**

If the error message still shows, then remove another digit till you get through

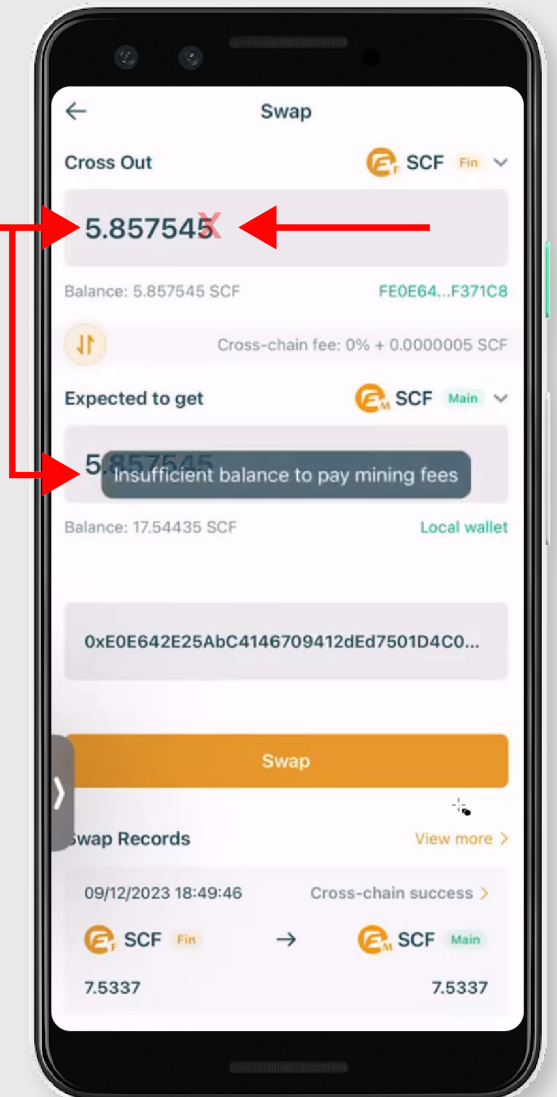

HOW TO SWAP - SCF FIN TO SCF MAIN

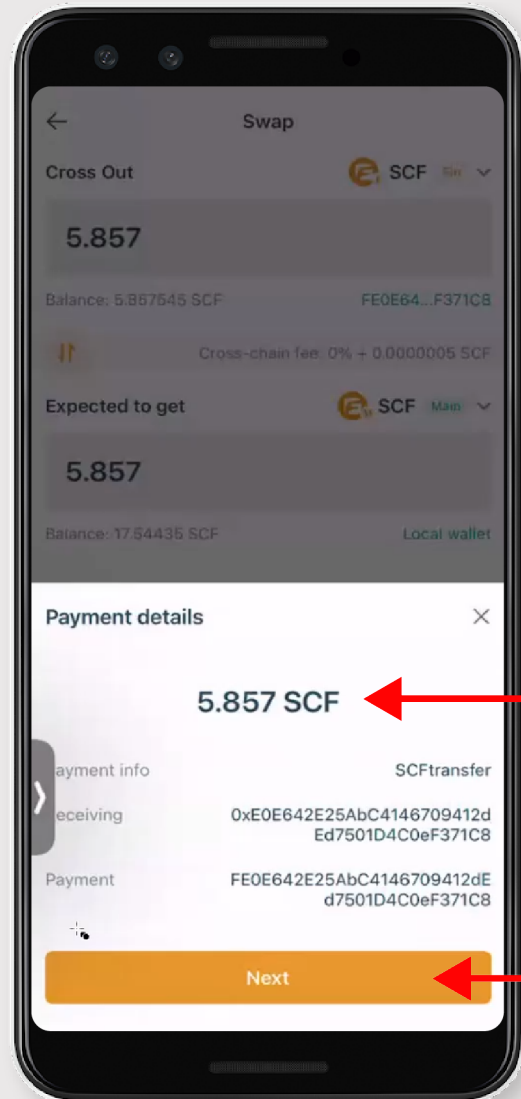

PAYMENT DETAILS SCREEN

Amount you will
receive

Tap on “Next”



Wallet password:
Input your wallet

Tap “Sure”

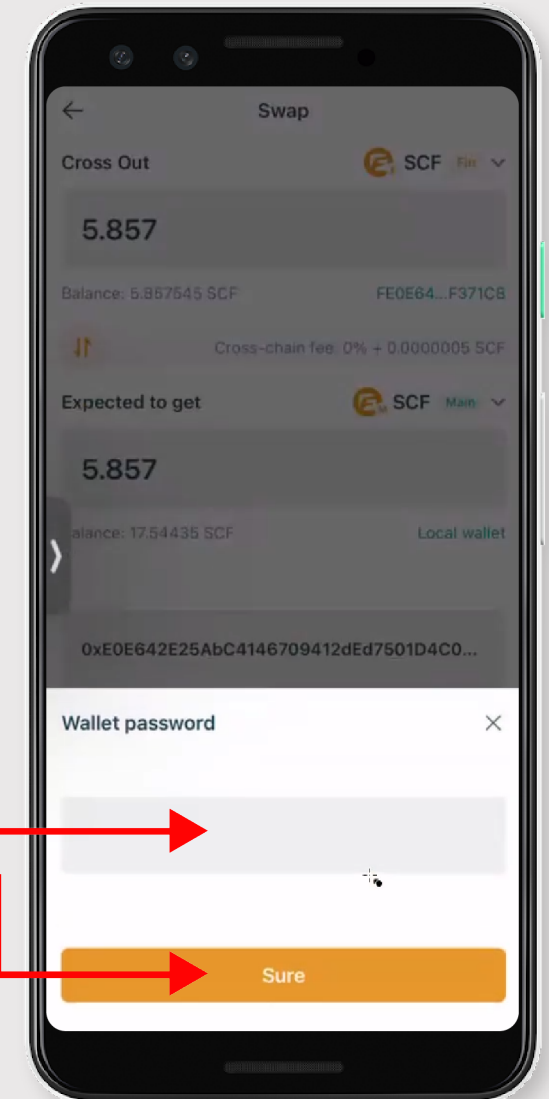

HOW TO SWAP - SCF FIN TO SCF MAIN

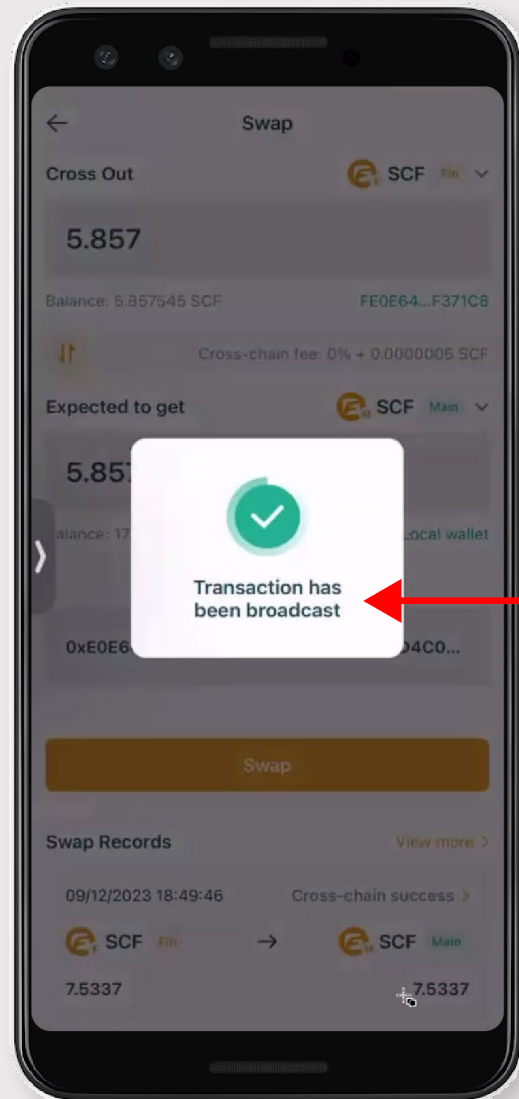

You will see the Transaction has been broadcast, pop up for a brief moment

In your SCF Wallet, you should see the SCF Main increased with the Swap from SCF Fin

